

# Dreamweaver

## Overview:

Dreamweaver without Photoshop is like jogging in flip-flops: you're getting exercise, but it's hard to go very far. Today we will build an interface in Photoshop for later use in Dreamweaver.

This Interface is based on a 3 column model, with rollover buttons for navigation, an expanding textured interface banner and a re-useable right hand column. To really understand this, you need to do it several times, it gets easier and better each time.

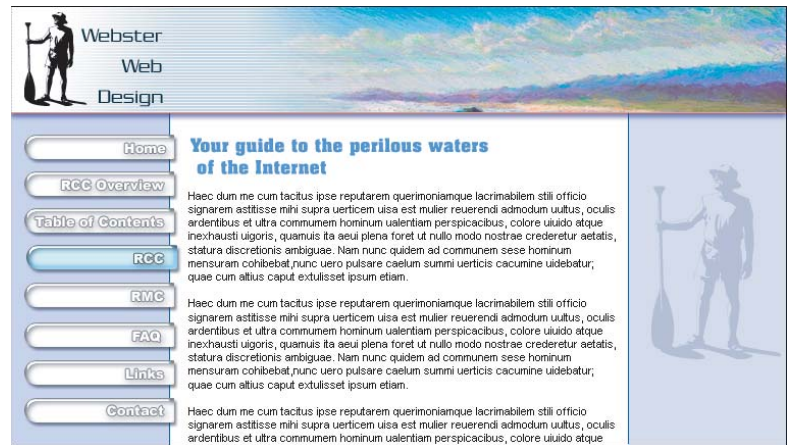

## The assignment:

- Build an interface in Photoshop

## Establishing the columns

**STEP ONE:** In Photoshop, click: “File>new” and make your new file 760 pixels wide by 430 pixels high with a resolution of 72 pixels per inch and a white background

**STEP TWO:** You will need to drag in some guides, but before you can do that, you need to have rulers visible because the guides live in the rulers. Click: “view>show rulers”

**STEP THREE:** right click on the top ruler and tell it to show percent.

**STEP FOUR:** Select the move tool (V). Click and drag from the left side ruler into your work area. This will drag in a guide.

**STEP FIVE:** Drag a total of three guides from the side ruler onto your work area ( 25%, 50%, 75% ) to divide the space into 4 equal columns. Tell the rulers to show pixels.

**STEP SIX:** To define the top interface area, drag one guide down from the top ruler. Align it with the 100 pixel mark on your ruler.

**STEP SEVEN:** If your rulers are not showing pixels, right click on the ruler and choose “pixels” from the pop up list.

**STEP EIGHT:** You should now have a blank white document divided into 4 columns and two rows. The top row should be 100 pixels high.

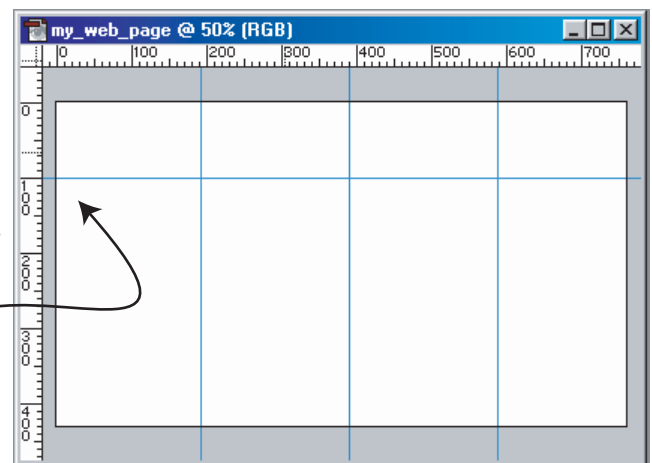
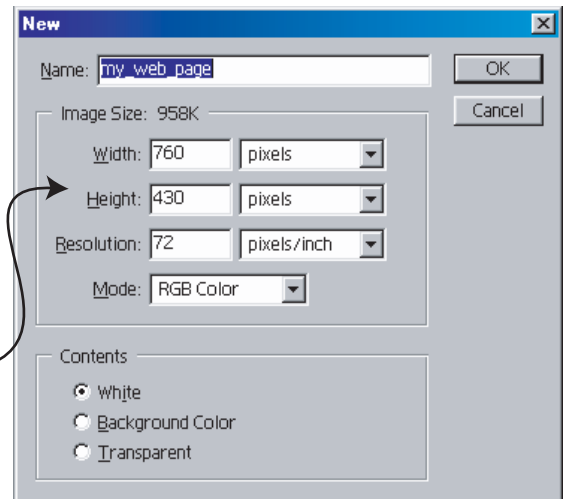

## Adding the place holder text

**STEP ONE:** Choose the text tool. Open the Character palette and choose 11 point black Arial. Set aa (anti-aliasing) to smooth.

**STEP TWO:** With the text tool, drag out a box of text that covers the middle two columns of the lower row.

**STEP THREE:** Fill the box up with random words. If you can't quickly find any text to copy in there, type a couple sentences, then copy and paste until you have placeholder text as shown. We put the place holder text in there to

remind ourselves that this area belongs to the client.

It is where he will pay us to put his text and widget photos.

DO NOT put any of your interface structure in this content area. It must be kept white with black place holder text during the interface work.

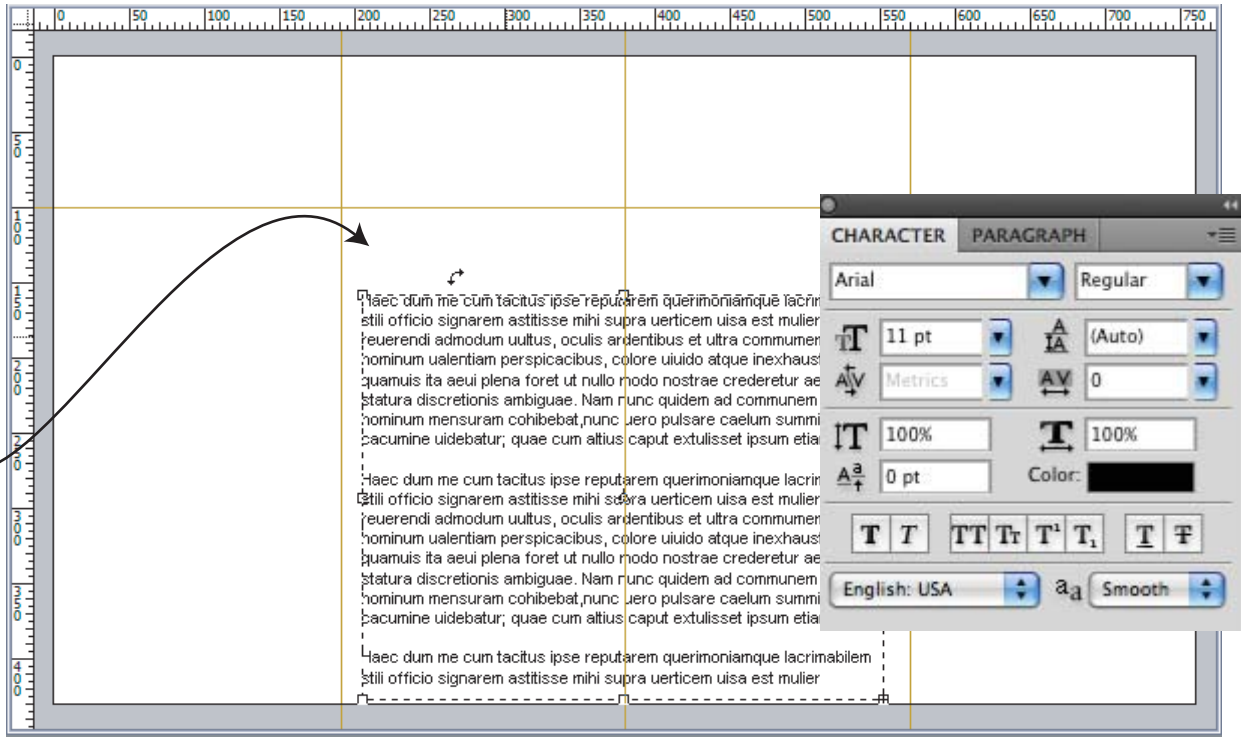

**STEP FOUR:** Add a new layer named “header”

**STEP FIVE:** Choose the text tool again. Set it up for 14 point blue. Choose any font you like, but make sure Anti-Aliasing is set to **Strong**. We may be saving this header text as a gif to put at the top of our content area. You can also make a nice looking header in the css style sheet, but your choice of fonts is limited in XHTML and CSS. If you want to have exotic fonts and special effects like a drop shadow on your header text, you will need to make it here in Photoshop.

**STEP SIX:** Click with the text tool above the placeholder text box and type a header for the page, for example: “Photography”

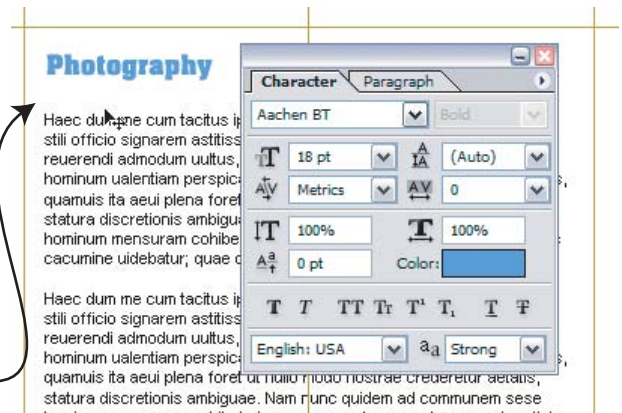

## Adding background columns

**STEP ONE:** We will be using the marquee tool to draw squares aligned with the guides. You need to have “snap” turned on. Click: “view>snap”, then click: “view>snap to>guides”

**STEP TWO:** Add a new layer named “left column”

**STEP THREE:** With the marquee tool, drag out a selection that snaps to the lower left cell.

**STEP FOUR:** Double click the color picker and choose a light blue. I chose: CCD2F6

**STEP FIVE:** Press “Alt+backspace” This will fill the selection on the “left column” layer with your foreground color, which should be blue.

**STEP SIX:** Deselect. (Ctrl+D)

**STEP SEVEN:** Choose the move tool (V), hold the “alt” key down and put your cursor over the blue column.

**STEP EIGHT:** You should see a double headed arrow. While you are holding the Alt key, begin dragging to the right and add the “shift” key. You are now dragging to the right while you are holding alt and shift together.

**STEP NINE:** Drag the duplicate blue rectangle over and drop it on the right side up against the side of the page.

**STEP TEN:** Your new column should appear on it's own new layer named “left column copy”. We need to merge the two column layers together to make them easier to edit. Click the flyout menu in the top right corner of the layers palette and choose: **merge down**, or press the keyboard shortcut which is Control+E

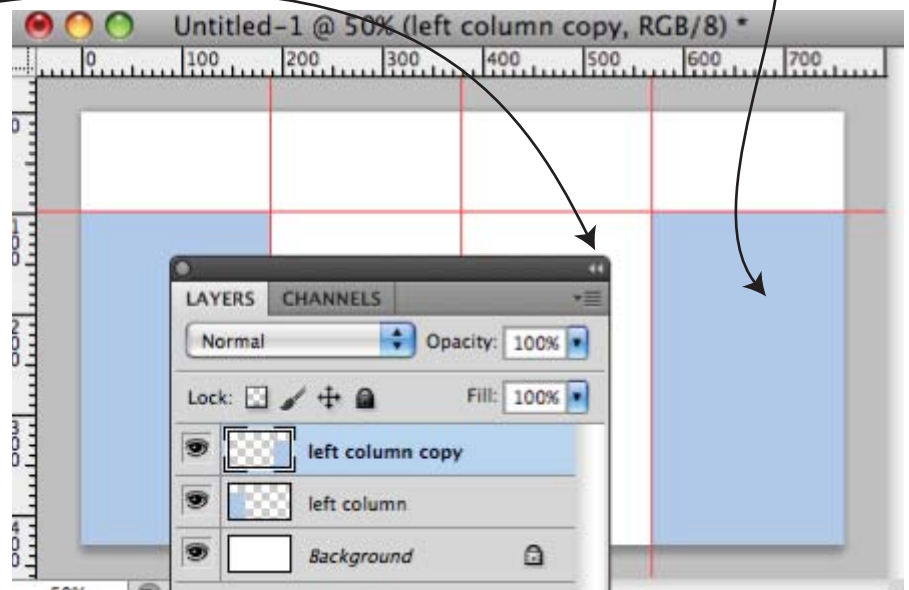
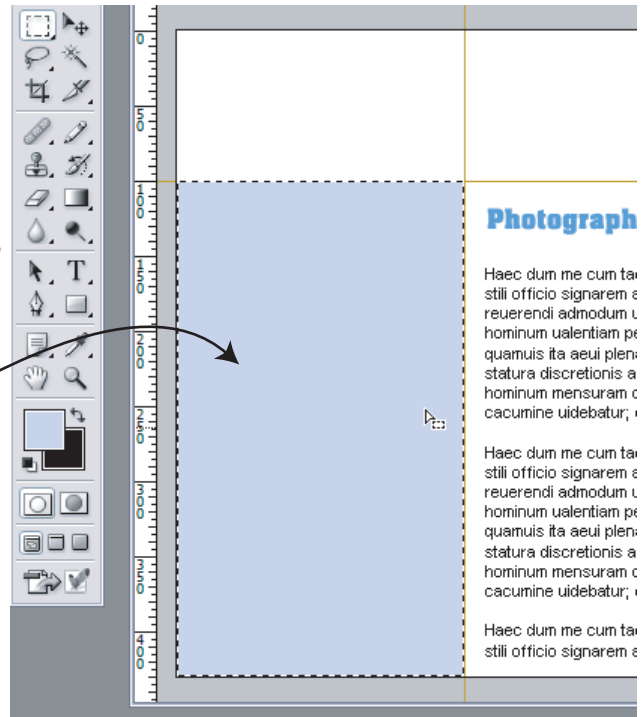

## Adjustment layers

**STEP ONE:** With the merged columns layer as the active layer, hold down the alt key and press the “Create new fill or adjustment layer” button. Check the box for “use previous layer to create clipping mask” and click OK.

**STEP TWO:** When the color picker pops up, click a different color and you should see your columns instantly change color.

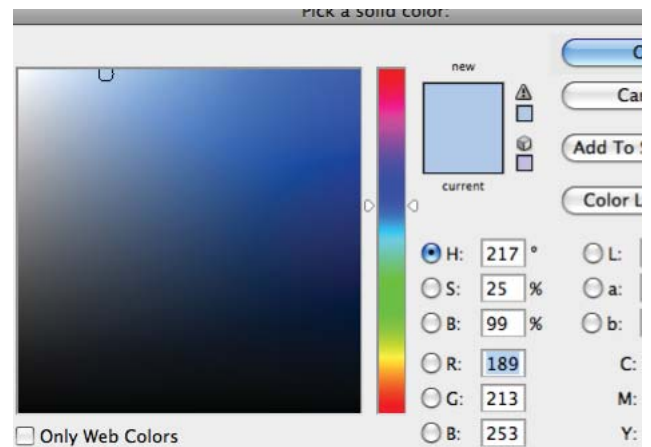
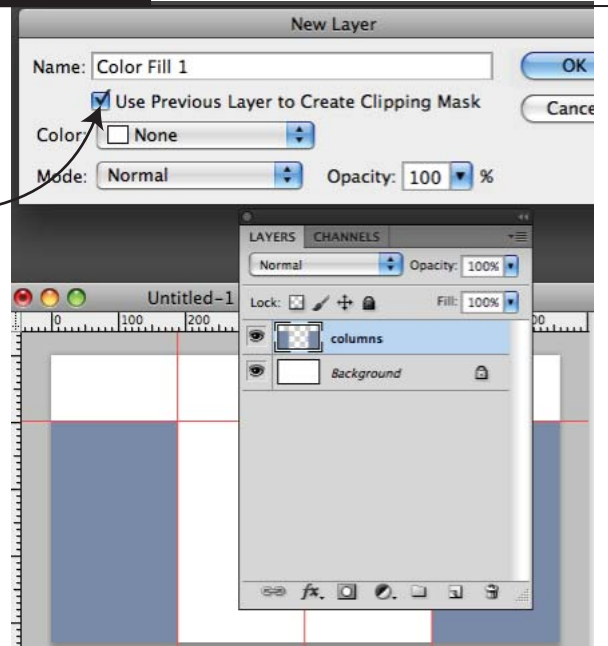

**STEP THREE:** If you change your mind later about the color in the color fill adjustment layer, double click the color picker on the layer and choose a new color.

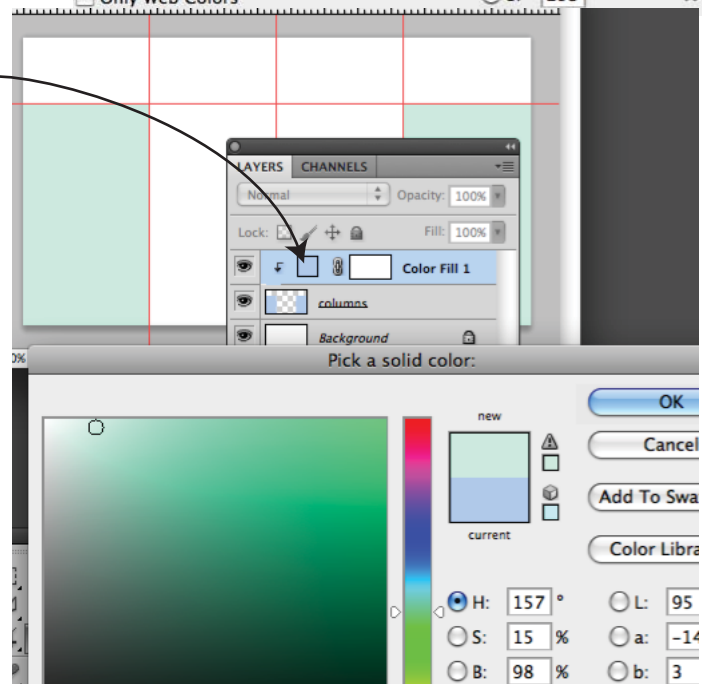

**STEP FOUR:** Not all of you have a good eye for color, but this does not have to be a problem when you need to design something with harmonious colors. Navigate to:  
[www.colourlovers.com/palettes](http://www.colourlovers.com/palettes)  
 or: <http://colorshemedesigner.com/>

## Finding a great color scheme

**STEP TWO:** Navigate around the [www.colourlovers.com](http://www.colourlovers.com) website until you find a pretty “palette” of color. Typically, if you aren’t blessed with an eye for color, you at least know good color when you see it.

**STEP THREE:** Make the web page small on your desktop so you can just barely see the color palette you like.

**STEP FOUR:** On a PC, hold down the alt key, and press the printscreen button. On a mac, hold down command+control+shift+4. This tells your computer to take a “picture” of whatever was the active software program, or, if you have a mac, enables you to drag a marquee around the part of the web page you want to take a picture of.

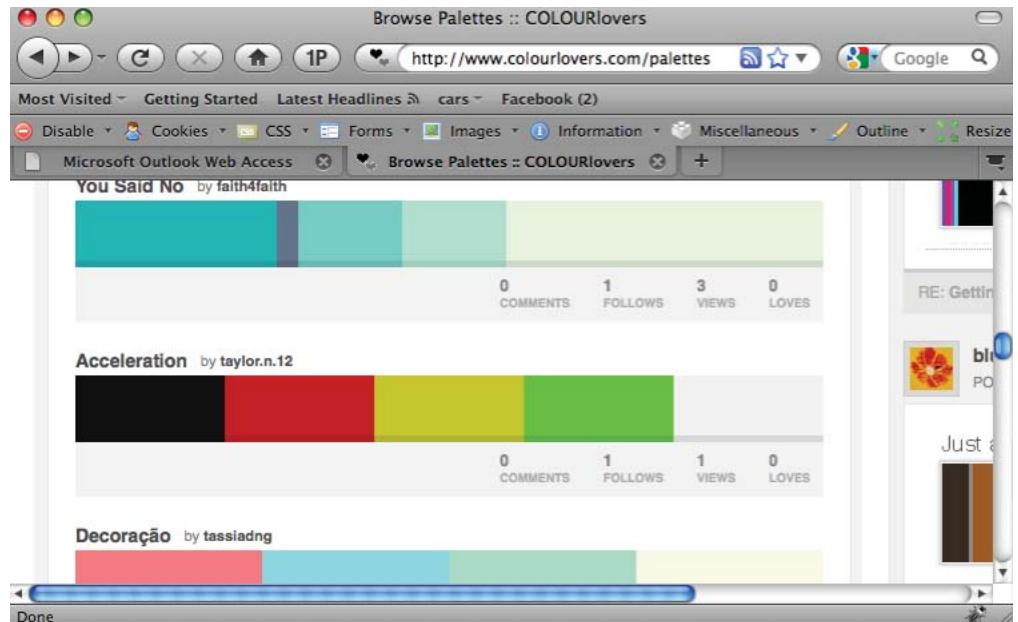

**STEP FIVE:** Switch to Photoshop, make a new layer called screenshot, and choose edit > paste. You should see the webpage come into Photoshop. We brought it in so that we could use it to sample colors from as we create a good looking web page interface.

**STEP SIX:** Press Control+t and shrink the screenshot down until it is useful, but does not cover up your interface columns.

**STEP SEVEN:** To use the color palette, double click the color picker on the columns layer adjustment layer, and eyedrop one of the colors in the color palette. Your columns will change to that color.

**STEP EIGHT:** Add a new layer named “right Vertical Pinline”.

**STEP NINE:** Select the pencil tool and choose the smallest brush = 1 pixel.

**STEP TEN:** Click on the color picker and select a dark blue color. I chose: 063BB4, or even better, use the eyedropper to select a pencil color from your color palette.

**STEP ELEVEN:** Hold the shift key, then click on the **bottom left** side of the **right** hand blue box and drag up to the top of the box to the horizontal guide (100 pixels from top) and release the mouse.

**STEP TWELVE:** To temporarily turn off the guides and see your line, press: “Ctrl+;” (Control+semi-colon)

**STEP THIRTEEN:** Choose the move tool (V). Drag the “rite vertical pinline” layer to the new layer button to make a duplicate.

**STEP FOURTEEN:** Rename the dupe: “left vertical pinline” then drag it over and set it on the **right** side of **left** column. Both lines should fit flush to the edge of their respective columns. These will become our vertical tiles in html, so keep them simple:  
(flat colors, no photos, gradients or spackle effects)

**STEP FIFTEEN:** merge the two pinline layers together: Ctrl+e. If you need to change the pinline color, add a color adjustment layer as we did on the columns.

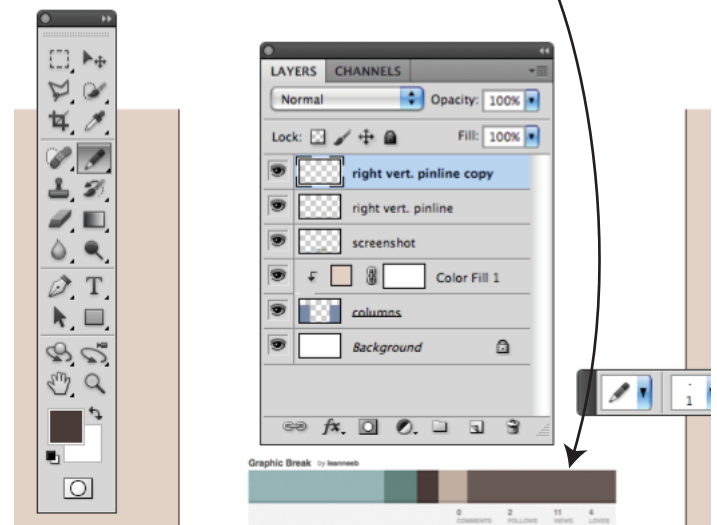

## Knocking out the glass buttons

**STEP ONE:** click top layer of your layers palette, and click the “group” button to create a group called “home button”

**STEP TWO:** Add a new layer within the group named: “button”

**STEP THREE:** Choose the “rounded rectangle shape tool”

**STEP FOUR:** Up in the Option bar, choose the “fill pixels” button.

**STEP FIVE:** Set the Radius at 12 px and check the Anti-Aliasing box.

**STEP SIX:** While watching your “info” palette, drag out a round button shape about 24 pixels tall and wide enough to cover most of the left hand column and hang over the right edge as shown. Make sure you have the “hang over” on the right, we will need that shortly.

**STEP SEVEN:** Open your “styles” palette and apply the “wow button 47 normal” style to the button layer. This should give you a clear beveled glass button. **NOTE:** If you don’t see the style, find the “Wow 7-20 Button Styles.asl” file in the Dreamweaver folder and drag it into the styles palette. On the mac, drag it onto the photoshop icon in the dock.

**STEP EIGHT:** Choose the “rectangular marquee tool” and drag out a little selection box that encloses the overhanging edge of the glass button.

**STEP NINE:** Press the delete key to cut off the round edge, leaving about 2 mm of squared off button hanging over the edge.

**STEP TEN:** Make a duplicate layer of the glass button and name it “white bottom”

**STEP ELEVEN:** Right click on the “layer effects” icon on the “white bottom” layer and choose “clear layer style”

**STEP TWELVE:** Drag the “white bottom” layer under the “button” layer.

**STEP THIRTEEN:** Choose the “move” tool (V) and control click the “white bottom” layer to get the marching ants around the button.

**STEP FOURTEEN:** Press the “D” key, then the “X” key and press “Alt+backspace”. This should fill the button with white. This white filled “white bottom” layer acts like a sheet of white paper between the glass button and the columns/vert pinlines layers.

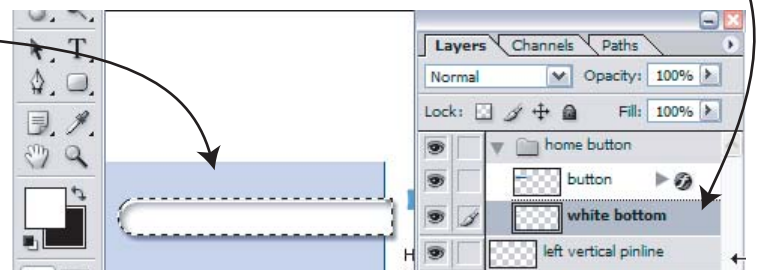
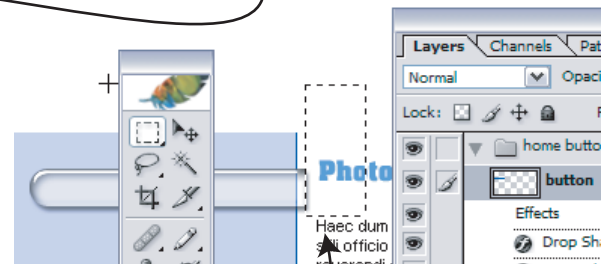
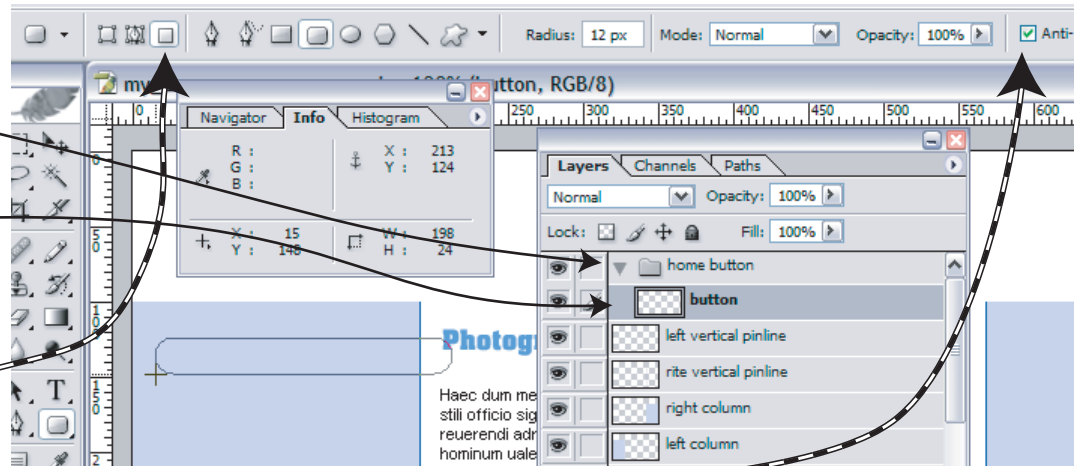

## Adding text and duplicating the buttons

**STEP ONE:** Click the top layer/button in the group, then choose the Type tool

**STEP TWO:** for color choose: white

- ▶ font: “Arial Black”
- ▶ size: 13 point
- ▶ anti-aliasing: smooth
- ▶ Paragraph: align right

**STEP THREE:** Type: “Home” in the space immediately below the glass bar

**STEP FOUR:** Choose the “move” tool and drag the text up onto the button. It will disappear because it is white, don’t worry.

**STEP FIVE:** at the bottom of the layers palette, click the FX button.

**STEP SIX:** Click the “Blending Options: Custom” line and lower the opacity to 53%. This will make all your other style choices inherit the 53% opacity setting, giving the type a soft etched glass look.

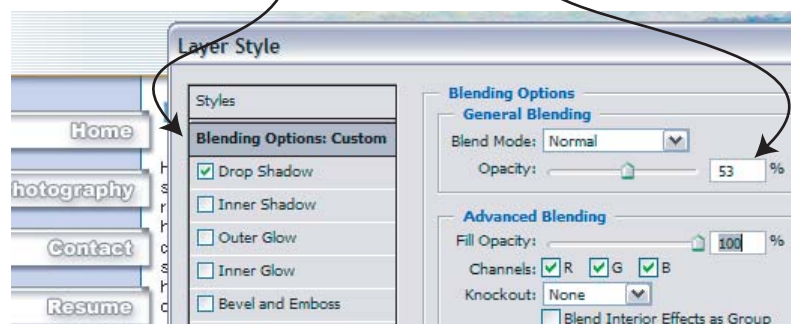

**STEP SIX-a:** Click the “Drop Shadow” line and choose 75% opacity with a distance of 3, spread of 0 and a size of 8

**STEP SEVEN:** Click the line for “Stroke”

- ▶ size: 1
- ▶ position: Outside
- ▶ Blend mode: Normal
- ▶ Opacity: 100
- ▶ Fill type: color
- ▶ Color: Black.
- ▶ Click OK

**STEP EIGHT:** This should give you a nice looking white glass button with hollow stroked black text.

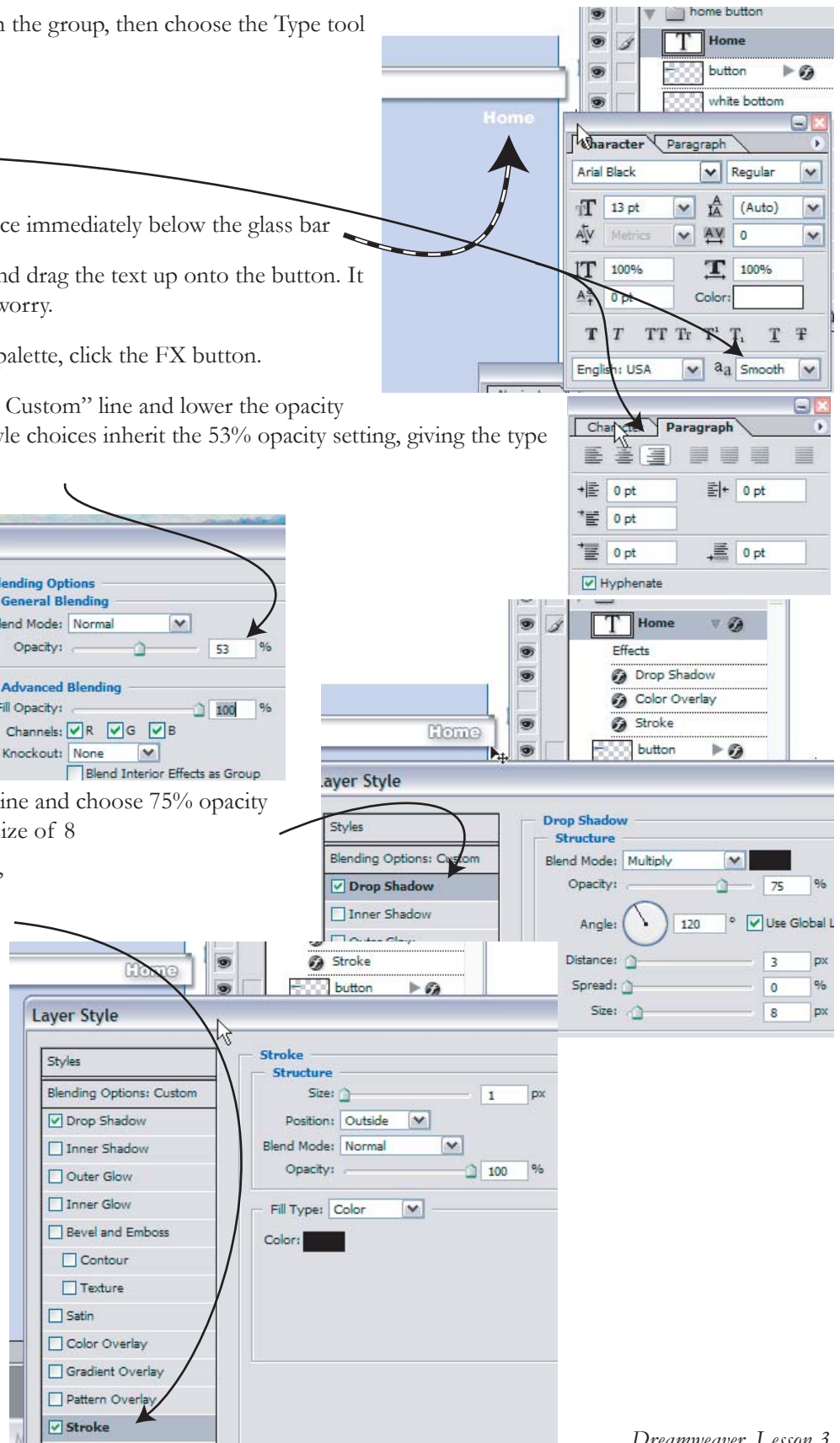

# Smoked glass buttons

**STEP ONE:** if time allows, there are further embellishments we can make to our button. Click the “white bottom” layer and add a gradient overlay layer style.

**STEP TWO:** Tell the gradient to go from left to right (instead of up and down) by dragging the dial on the circle to point at 3 o'clock.

**STEP THREE:** Click the gradient editor color ramp to launch the gradient editor.

**STEP FOUR:** Double click the lower left gradient slider to launch the color picker for that tab on the gradient.

**STEP FIVE:** click in the top right corner of the color picker to get the richest hue, and then drag the rainbow slider until your button looks like it is an illuminated glass tube with colored smoke in the left end. Try to pick colors for the glass buttons that compliment what you already have in your design.

**STEP SIX:** Right click on the button layer and choose duplicate layer, name the new layer Rollover.

**STEP SEVEN:** apply a different style to the rollover layer, and then color code the rollover layer yellow, and the button layer green. (right click the eyeball, select color)

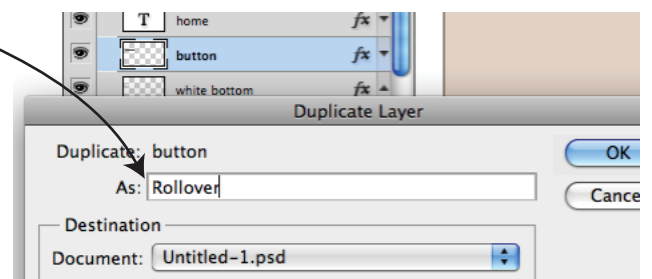
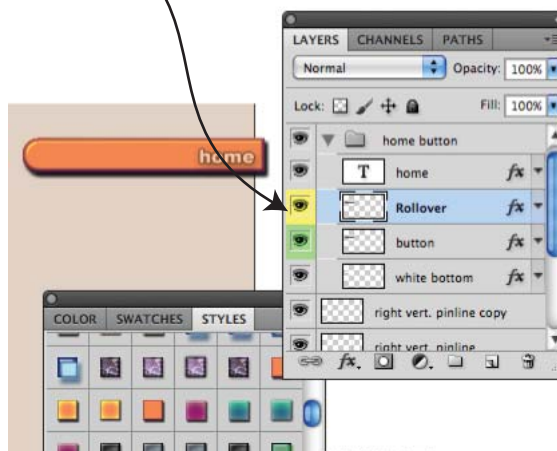
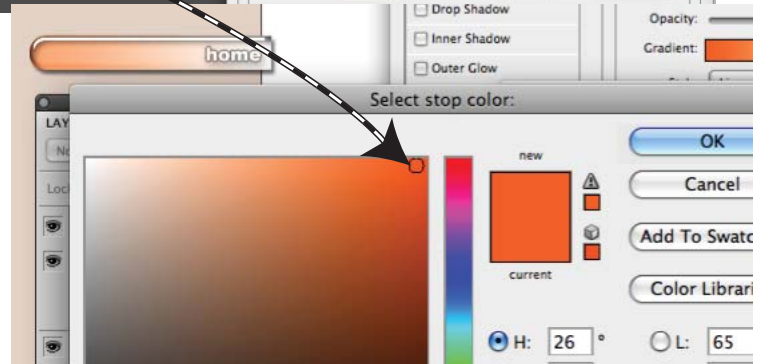
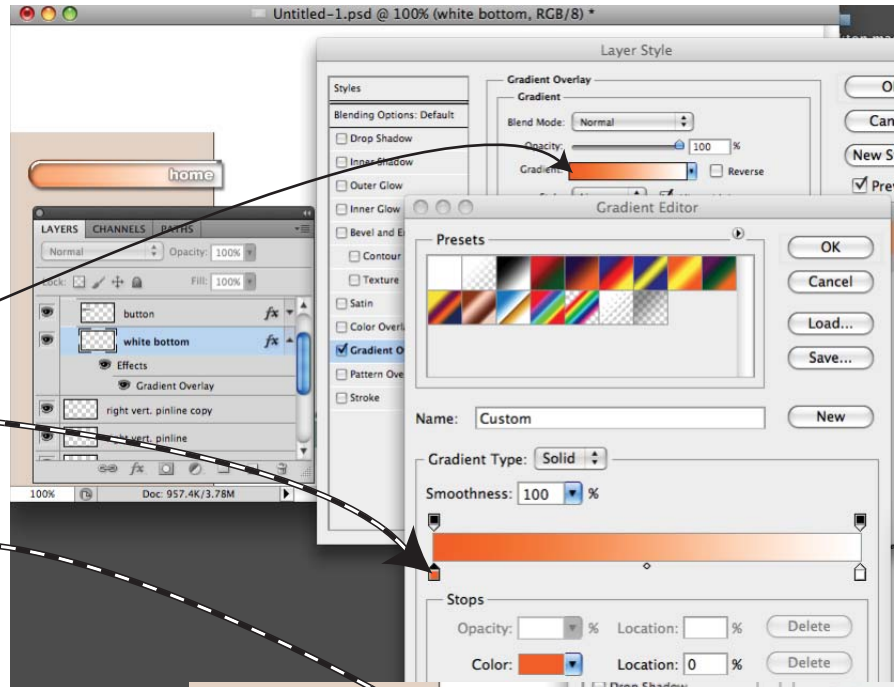
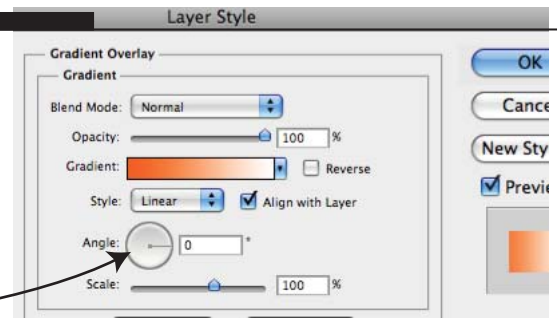

## Duplicating your buttons

**STEP ONE:** to see how your rollover button will look on your webpage, turn visibility on and off for the yellow rollover layer. When you are satisfied with your rollover button, hide the yellow rollover layer.

**STEP TWO:** Fold up the home button group. Turn visibility on and off for the group. The entire button should disappear. If it does not, organize your layers palette so that all the button layers are in the home button group.

**STEP THREE:** right click on the home button group and choose duplicate group. Name the duplicate group: gallery button.

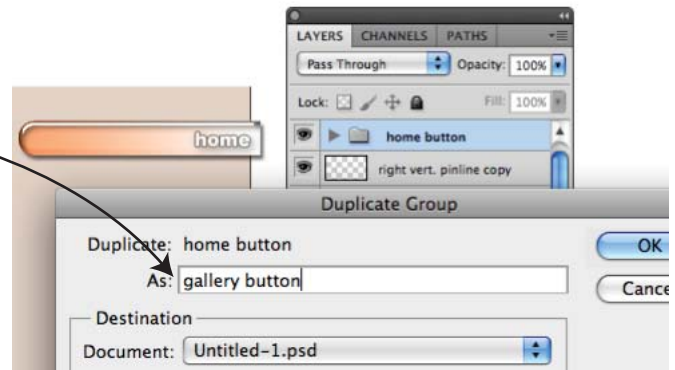

**STEP FOUR:** choose the move tool (v) and press the down arrow until your new gallery button moves into position below the home button.

**STEP FIVE:** expand the gallery button group and double click the “T” text icon. This will select the word home, which you need to edit to read: **gallery**.

**STEP SIX:** Repeat steps three through five until you have four total buttons: home, gallery, resume and contact.

**STEP SEVEN:** Temporarily turn on the yellow rollover layers in each of your buttons. Make sure that the outer glow, or drop shadows that may be coming off the buttons do not overlap adjacent buttons. If they overlap, move the button groups further apart until you have at least 5 pixels of clearance between buttons, in both normal and rollover states.

**STEP EIGHT:** Hide visibility for all of the yellow rollover layers in all 4 button groups. Think of this as: “turning off the lights when you leave the room.”

**STEP NINE:** It’s not required, but for organizational purposes you may want to drag the button groups up and down in the layers palette until the home button group is on top, and the contact button group is on bottom, just like they are in the document.

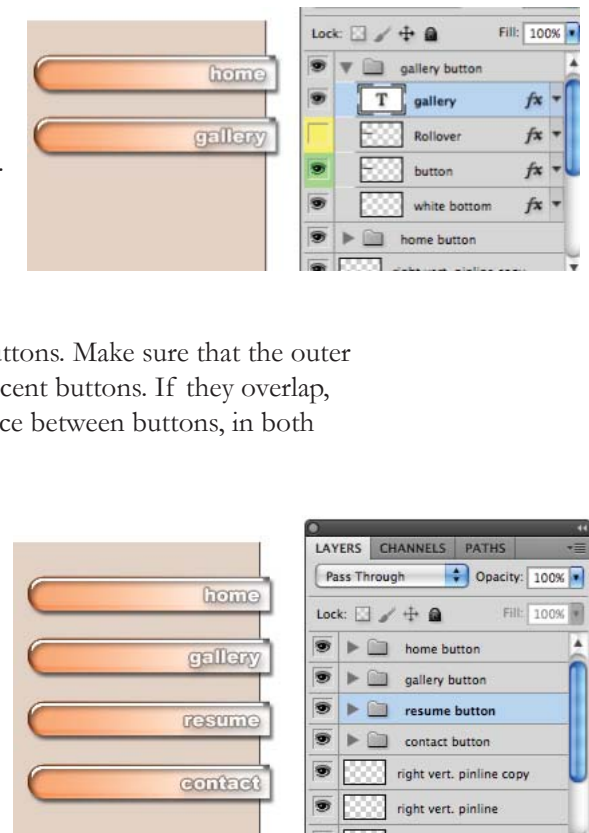

## Preparing the banner

**STEP THREE:** Add a new layer at the top of your stack of layers named “banner”

**STEP FOUR:** If your guides are hidden, turn them on. (Ctrl+;) Drag a marquee across the entire top row of the interface. It should snap to the guides if you have snap active under the view menu.. In the “info” palette it should measure about 760 wide by 100 high.

**STEP FIVE:** choose “CDDDE9” for your foreground color and press “alt+backspace” to fill the banner area with a light blue green, or a color sampled from your color scheme pattern.

**STEP SIX:** Leave the selection active. Add a new layer called “pinlines”.

**STEP SEVEN:** click “edit>fill”.

choose “Pattern” for contents

click the “custom pattern” droplist.

choose the little white over transparent pattern, it may be named “1x3pinline”.

If it is not there, see the last page of this handout, we may have to make it from scratch.

**STEP EIGHT:** Click OK to apply the pinline pattern.

Adjust the pinline layers opacity setting until the pinlines are just barely there. They are supposed to add texture to the banner, not dominate it. You can easily change the color of the pinlines by adding a color adjustment layer to them, as we did on the side columns.

NOTE: you won’t be able to see the pinlines correctly if you are not viewing the document at 100%.

**STEP NINE:** Double click the “banner” layer and add a drop shadow, turning down opacity to 60%. Also check the Stroke box, changing the size to 1, color: “FCA001”

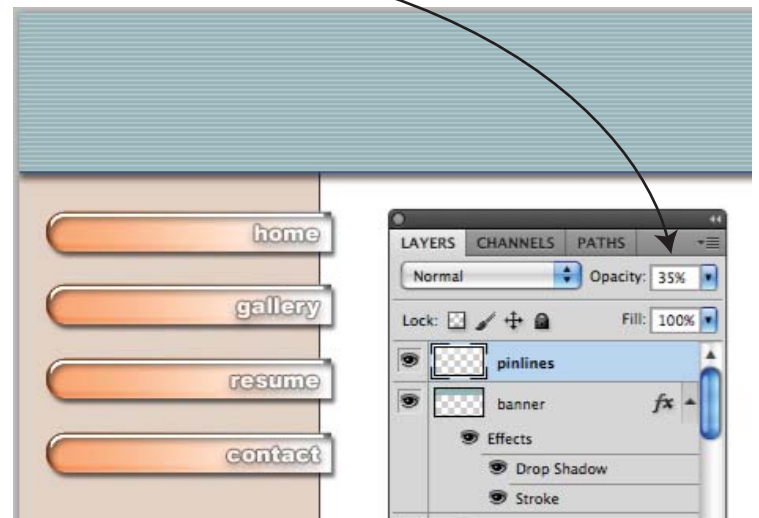
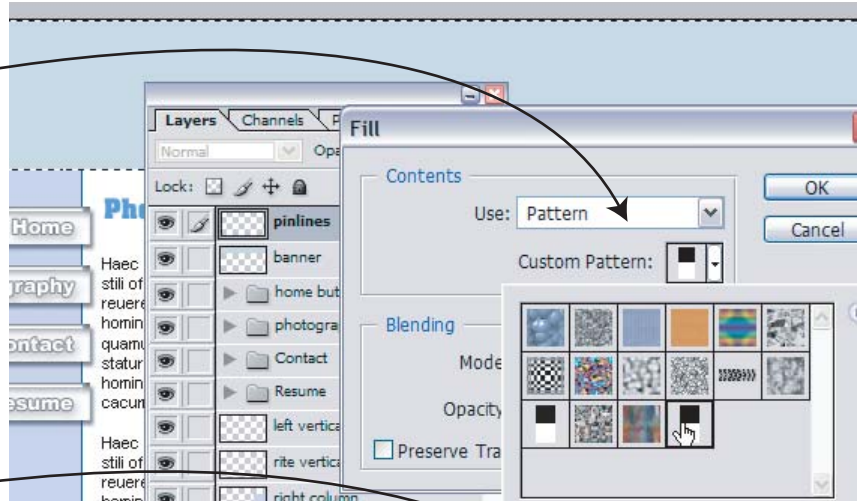

# Masking the banner photo

**STEP ONE:** Add a new layer **between** the “banner photo” layer, and the “pinline” layer named “banner photo”

**STEP TWO:** find a large photo somewhere and paste it in. The photo **MUST** be at least 700 pixels wide.

For student projects, you can find free images here:

<http://www.dpchallenge.com>. To copy them to your clipboard, you will have to use the alt+printscreen trick as we did on the color palette. **DO NOT** steal images for client work (where you are getting paid).

If the picture comes in from the clipboard with the browser window around it, drag a rectangular selection around the image that excludes the browser window pixels. Invert the selection and press delete.

**STEP THREE:** Control click the “banner” layer to get the 760x100 pixel **marching ants selection**.

**STEP FOUR:** With the “banner photo” layer active, press the “add layer mask” button at the bottom of the layer palette.

**STEP FIVE:** This should mask off your photo.

**STEP SIX:** Uncheck the “link” icon between the two icons on the “banner photo” layer, then click the left hand icon on the layer (the one with the color thumbnail)

**STEP SEVEN:** Choose: “edit>free transform” (Ctrl+T)

**STEP EIGHT:** Shrink and/or rotate the photo until it looks good, but don't let it get too close to the left hand column

**STEP NINE:** Activate the marching ants selection again on the banner area and click the **mask** icon on the “banner photo” layer

**STEP TEN:** Choose the brush tool, and pick a soft round brush. Set the size to 154 px, with a hardness of 0%. Set the opacity of the brush to 6%. Choose Black as your foreground color.

**STEP ELEVEN:** Make sure the mask is the active icon on the banner photo layer. With a series of short paint strokes, paint black on the left side of the banner photo mask until the image completely disappears on it's left side as shown.

**NOTE:** You must have at least 30 pixels of flat banner and pinlines to the right of the left column before your image begins to appear.

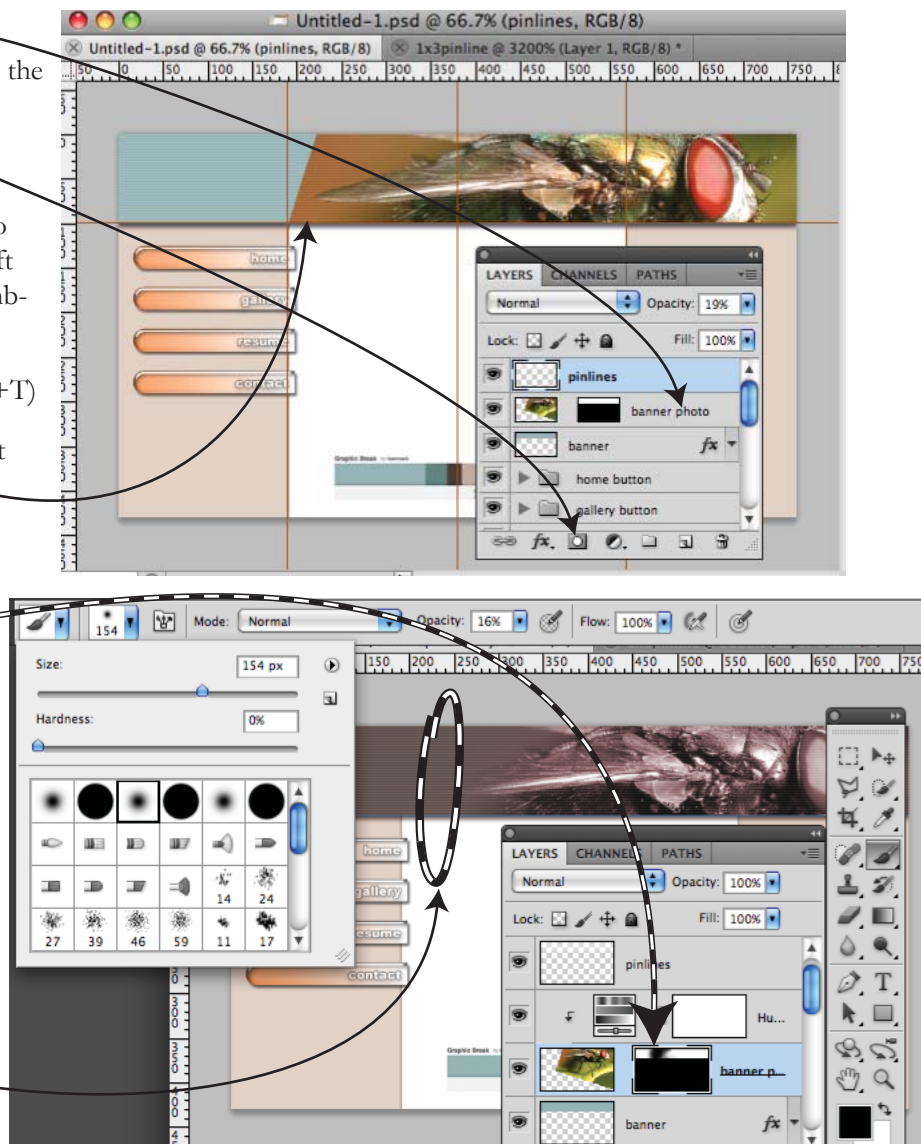

## Masking the banner photo

**STEP ONE:** Press the alt key and click the mask. Photoshop will hide the image and show you the mask alone. You need to have 100% black paint in the area of the banner that is over the right hand side of the left column. This assures that the photograph is completely masked out, leaving just the pinline pattern, and the flat banner color. Add black paint if needed until the mask is completely black in that spot, with a gradual feather to white off to the right, as shown. Alt click the mask to get back to the color view.

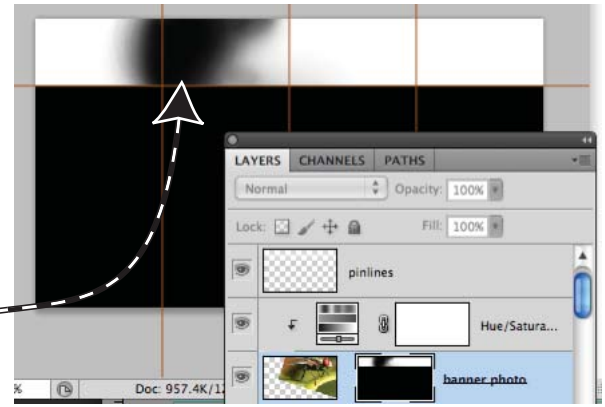

**STEP TWO:** If you have a logo you would like to place up in the top left hand corner of your banner, you can drag it across from Illustrator, or simple type your initials in a large fat font (Arial Black) and apply a style. The logo needs to go on a new layer at the very top of the layer palette.

**STEP THREE:** To make the logo stand out better, you can add a new layer called “white fade” above the pinlines layer, but under the logo layer, and paint in a “mist” of white under the logo to sort of lift it off the banner using the same brush we used on the mask. You can also add the white “mist” by dragging out a white to transparent gradient. Make sure you have your banner selection active before you do this, you don’t want the white paint to get down onto the button area, and don’t let the white paint go beyond the guide.

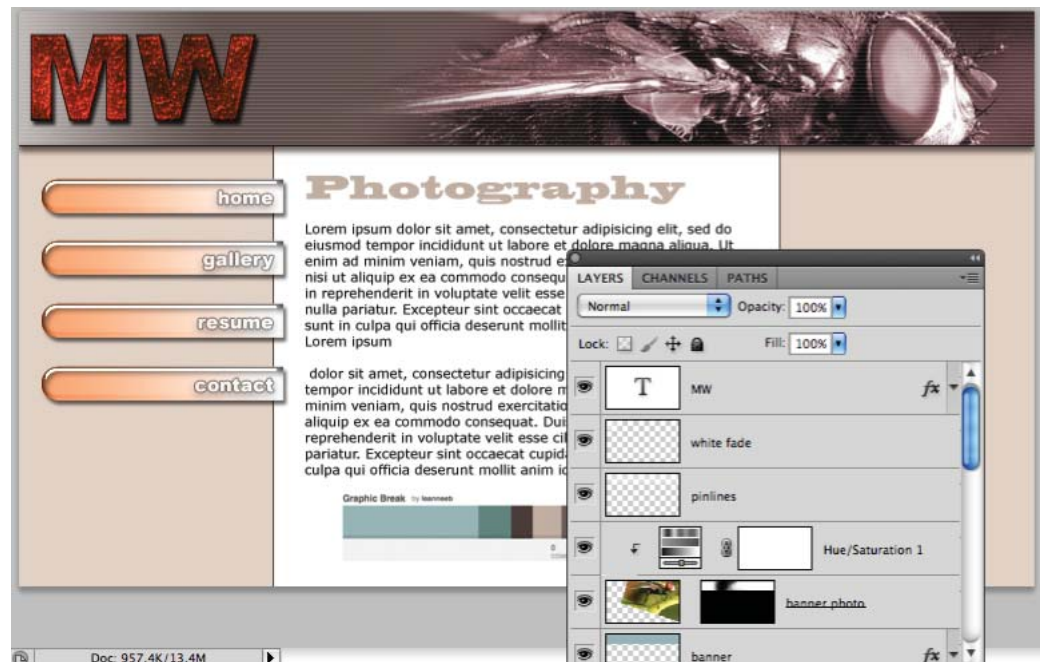
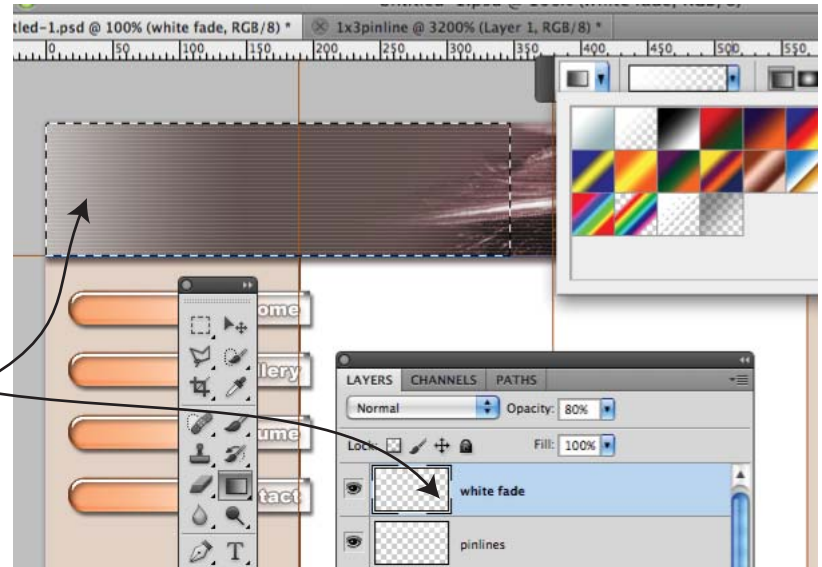

## Interface expansion joints

Note the expansion areas circled on these web page interfaces. These flat or linearly textured areas must be built into the Photoshop Interface before it can be sliced.

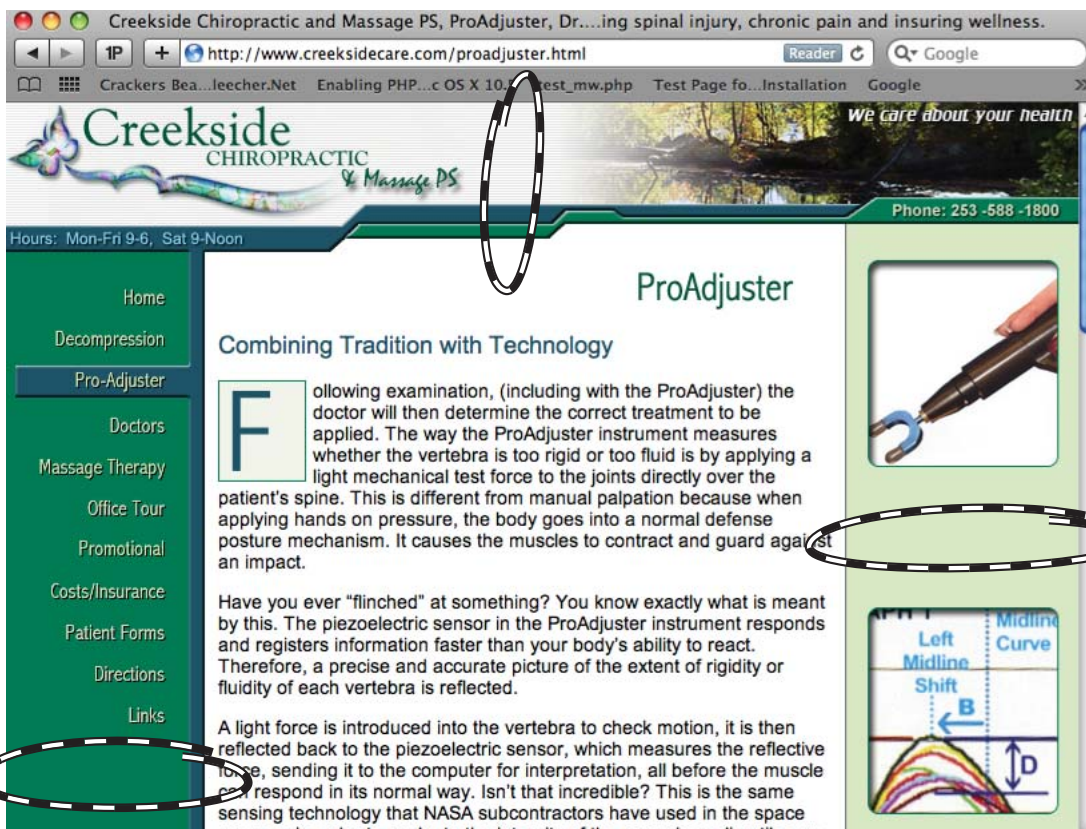
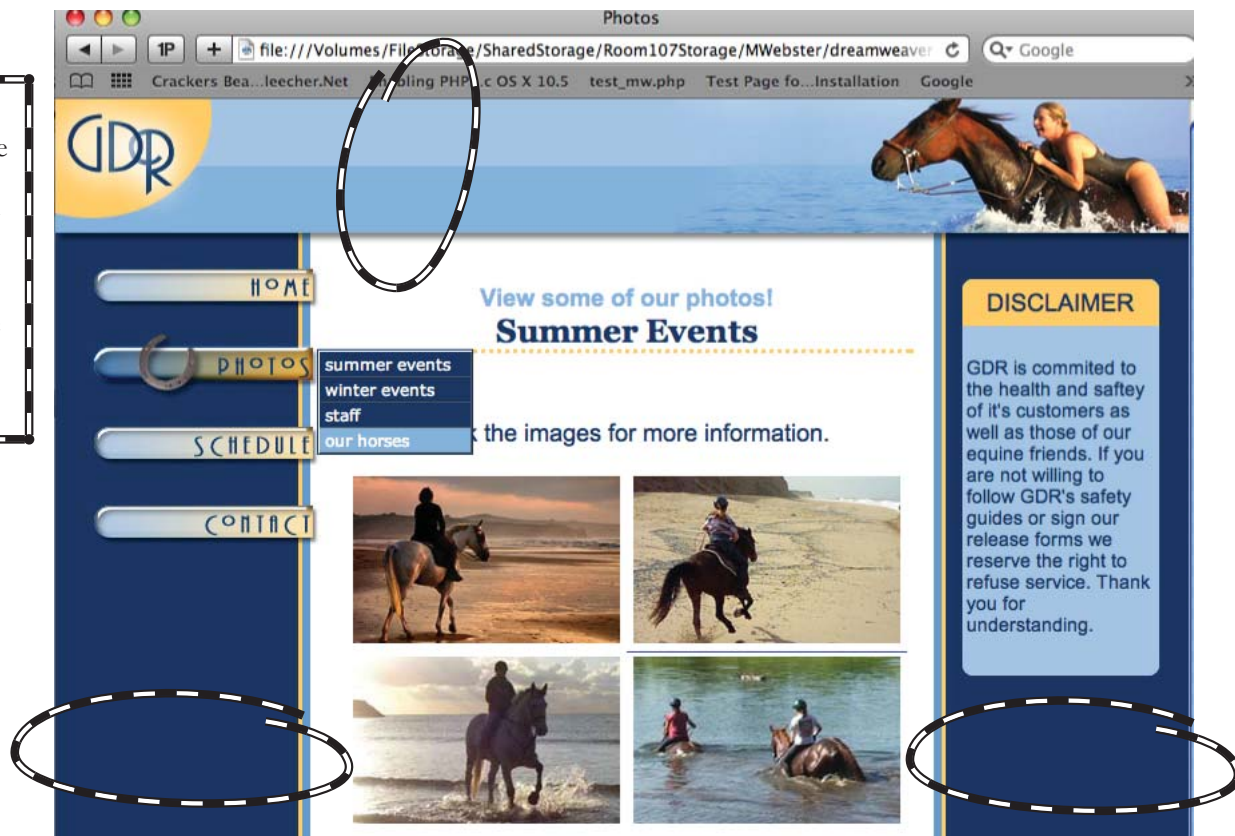

## Gradients in the columns = trouble

**STEP ONE:** Every quarter I have someone ask me if they can put gradients in the columns. Yes you can, but it causes problems. If you insist on doing this, these tips will minimize the problems. Add the gradient as a gradient overlay layer style to the columns layer.

**STEP TWO:** Click the gradient color ramp to edit the gradient. Pick the colors for the gradient by double clicking the bottom left and right tabs in the gradient editor. Also, tell the angle of the gradient to be a negative ninety.

**STEP THREE:** Once you get the gradient you want, drag the right hand gradient tab to the left this far.

**NOTE:** This will flatten out the gradient towards the bottom of the column, which in turn will give us the flat color we need when we slice out a pattern tile called "left\_tile" and "right\_tile", in the next lesson.

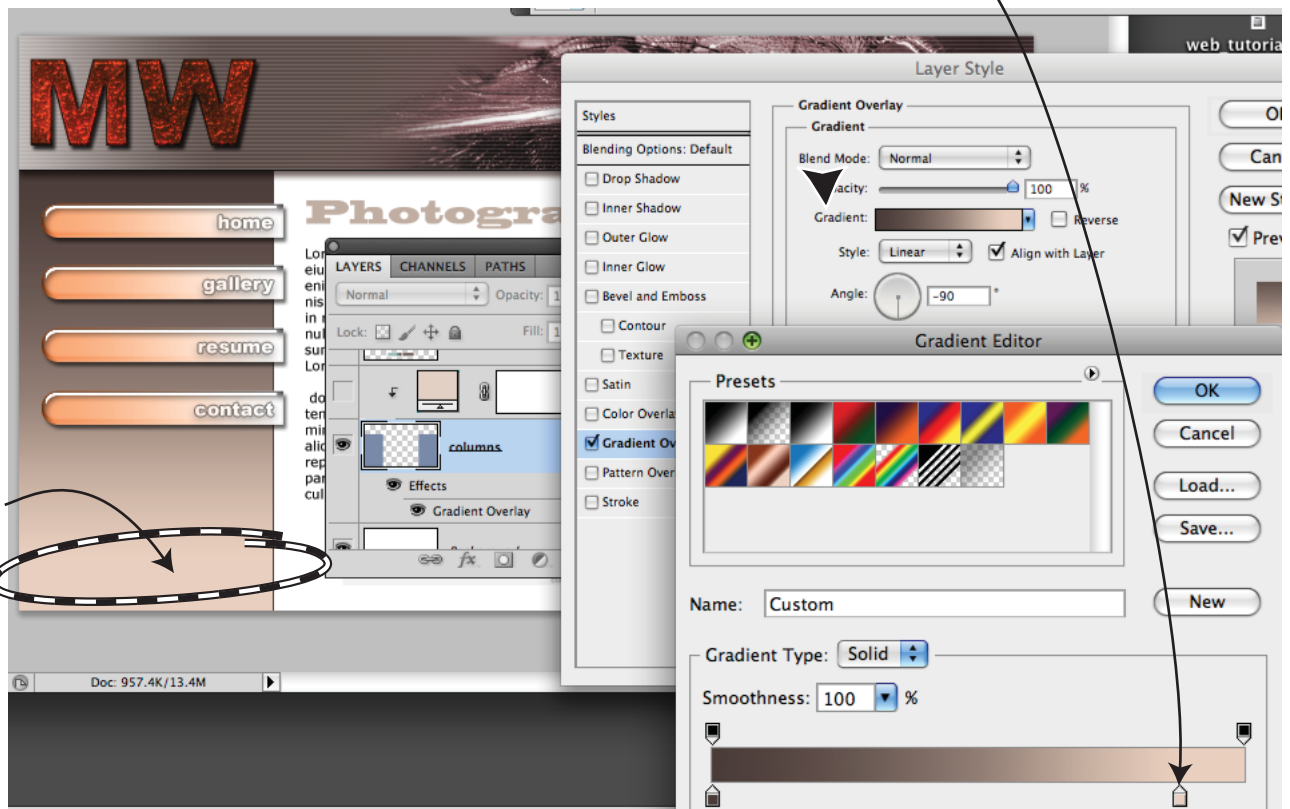

**STEP FOUR:** There will be other problems related to the gradients in the columns later, when we put content in the columns, but they can be solved with CSS. Be prepared however, to spend some extra time in the labs working out the bugs. You can also have pictures behind your buttons, but again, you have to find a way to make the pictures dissolve to flat color at the bottom of the column.

## Creating a Custom Pinline Pattern

**STEP ONE:** If you want to try making your own custom pinline, create a new Photoshop file:

- ▶ name: **1x3pinline**
- ▶ width: **1**
- ▶ height: **3**
- ▶ resolution: 72 pixels/inch
- ▶ background contents: **transparent**
- ▶ click OK

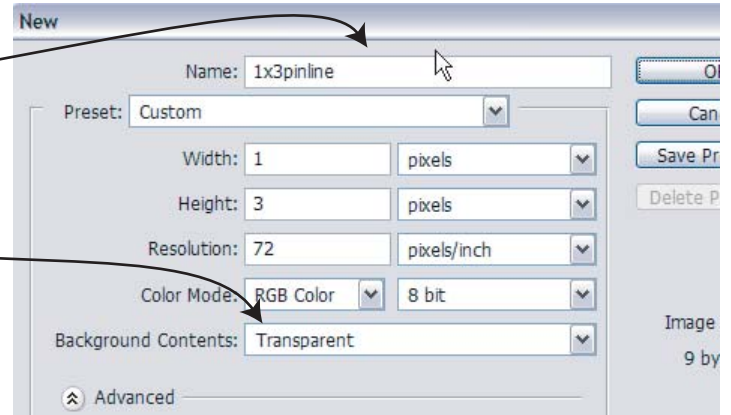

**STEP TWO:** Zoom into 1600% and display your “info” palette

**STEP THREE:** Make sure white is your foreground color and choose the Marquee tool

**STEP FOUR:** drag a out a 1x1 pixel selection in the top and press “alt+backspace” to fill the 1 pixel square selection with white.

**STEP FIVE:** Deselect (Ctrl+D), then press “Ctrl+A” to select all. This should give you marching ants around the whole file and your info palette should say 1x3.

**STEP SIX:** Choose: “edit>define pattern”

**STEP SEVEN:** Name it “1x3pinline” if it isn’t already and click OK. Photoshop will retain this pattern indefinitely.

**STEP EIGHT:** The reason I made the background transparent is this gives you more options and less confusion when you are experimenting with your pinline effects. Now that you know the secret, you can use this technique to make 1x6 pinline and little white dots, not to mention white boxes, use your imagination.

